

**Electrolux Central Vacuum Systems**

---

**OPERATING AND  
MAINTENANCE INSTRUCTION  
MANUAL**

---

**Read This Manual Thoroughly Before Use**



**Electrolux**





**Electrolux Central Vacuum Systems**

# Operating and maintenance instruction manual



## **WARRANTY INFORMATION**

Read this manual thoroughly before use.

## **IMPORTANT SAFETY INSTRUCTIONS**

When using electrical appliances, basic safety precautions should always be followed, including the following: Read all instructions before using this vacuum.

**NOTE:** Your Electrolux Built-In Vacuum is listed and approved by the appropriate agencies for dry pick-up only. Please see your rating plate for details. To reduce the risk of electrical shock, DO NOT USE on wet surfaces.

## SAVE THESE INSTRUCTIONS

### DANGER

Always unplug power unit from the electrical outlet before servicing and cleaning.

### WARNING

To reduce the risk of burns, fire, electric shock, or injury to persons:

- Keep cord away from heated surfaces.
- Do not allow vacuum to be used as a toy. Close supervision is necessary when this vacuum is used by or near children.
- Use this vacuum only for its intended use as described in this manual. (Use of attachments not recommended by manufacturer may cause fire, electric shock, injury or damage to system components.)
- Never operate this vacuum if it has a damaged cord or plug, if it is not working properly, or if it has been dropped or damaged. Return to your authorized Electrolux dealer for repair.
- Do not pull or carry this power unit by supply cord, or use cord as a handle.
- Never disconnect plug by pulling cord. To disconnect from outlet, grasp the plug, not the cord.
- Do not put any object into openings. Do not use with any opening blocked. Keep free of dust, lint, hair and anything that may reduce air flow.
- Keep hair, face, fingers, and all body parts and loose clothing away from any openings.
- Do not pick up cigarettes, live hot ashes, matches or similar materials.
- Never operate vacuum without dust bag and/or filter in place.
- Turn off all controls before unplugging.
- Never handle plug, cord or power unit with wet hands.
- Do not use on wet surfaces.
- Use extra care when cleaning on stairs.
- Do not use to pick up flammable or combustible liquids such as gasoline or use in areas where they may be present.
- Connect to a properly grounded (earthed) outlet only. See grounding (earthing) instructions.
- Do not block the motor hood ventilation openings on top of the power unit, lack of ventilation airflow will cause the motor to overheat.
- Do not locate the power unit in a high temperature area or where it is inaccessible, for example, an attic or crawl space.
- Mount the built-in vacuum system power unit at least 12 inches from the floor, ceiling and adjacent sidewall to insure adequate ventilation for the motor.
- Do not use extension cords or outlets with inadequate current carrying capacity.

## Introduction

Congratulations! You are now the proud owner of a Electrolux Built-in Vacuum System . . . . the ultimate in cleaning equipment. Say “good-bye” to old fashioned sweepers. You’ll never have to lug a heavy, awkward vacuum again. Your Electrolux Built-in Vacuum will change your cleaning routine. It is so easy and versatile to use. It’s quiet and dust-free. It will help eliminate the drudgery of vacuuming and give you a cleaner, healthier indoor environment. Before you use your Electrolux Built-in Vacuum System, read this manual carefully. Learning the proper way to use this system will help give you years of trouble-free cleaning performance.

## Operation

To operate, simply plug the hose into one of the handy wall inlet valves. The metal ring on the cutoff of the hose will complete a low-voltage electrical circuit, which in turn activates a relay and turns on the system’s power unit. To turn off the power unit, simply unplug the hose from the inlet. *Please Note: When unplugging the hose, it is recommended to hold the inlet door open for a few seconds until the suction pressure has sufficiently decreased.* For safety purposes, a low-voltage circuit is utilized at the wall inlet. The power unit functions on a standard 110/120-volt circuit. There are optional hoses available with an on/off switch located on the handle. *Please note: When using one of these optional hoses, it is important to properly align the hose with the wall inlet when plugging it in to prevent damage to the unit.*

## Power Unit

Electrolux power units are equipped with 115/120-volt by-pass motors. Electrolux power units also employ a manual reset circuit breaker. Electrolux’s self-cleaning filter provides complete protection of the motor fan assembly. It is normal for some dirt and lint to cling to the filter. However, the filter should be checked occasionally to be sure it has not been punctured or torn. The dirt receptacle should be emptied two or three times a year on the average depending on the amount of use. For best results, empty the canister when it is about half full. Any dirt spilled can be vacuumed up quickly by plugging the hose into the utility inlet located on the power unit. The on/off button on the power unit will start and stop the power unit. No part of the unit requires lubrication.

## Electrical Fault Protection

The central vacuum system employs features that monitor the following operating levels: AC voltage, current draw and circuit board temperature. If the voltage is below or above the standard operating voltage, high current draw or locked rotor, the power unit will not operate. In this case the LED next to the on/off button will blink until the problem ceases. If the circuit board reaches an elevated temperature, the power unit will not operate and the LED will be off. In the event of these problems happening, press the on/off button, unplug hose, or wait for temperature to lower. If problems persist; contact the authorized service center nearest you.

In the case of power failure, the power unit will return to its previous state when power returns. For example, if a hose is plugged in with the hose switch on, or a straight air hose is plugged into a wall valve, then the power unit will turn back on. If the power unit was turned on at the unit prior to power loss then the unit will not turn back on.

## Hose Use And Care

For optimum benefit, the hose should be used and stored at temperatures above 40°F (5°C). Always hang up the hose when not in use using the hose hanger supplied. If hose should become clogged, insert the wand end into the utility inlet on the power unit. Turn on the power unit with the manual switch and seal the extra air-space by holding the hose firmly. The obstruction should be quickly vacuumed out. If, however, the hose remains clogged, insert an electrician’s fish tape (wire) or garden hose through the hose to remove the obstruction, being careful not to puncture the hose. Disconnect hose handle from wands before storing. DO NOT store hose in direct sunlight.

## Installation Of Power Unit

The power unit hangs on the mounting bracket which is screwed to the wall. The bottom screws of the mounting bracket should be about 48" (122 cm) up from the floor to allow convenient removal of the dirt receptacle. For proper motor cooling, there must be at least 12" (31 cm) between unit and the ceiling (see Figure 1). If mounting on plaster or panel walls, be sure mounting screws enter studs. If mounting on concrete wall, drill the wall with a masonry bit and insert the appropriate wall anchors. Strip the low-voltage wires that were installed with the main trunk line. Connect the wires to the spring loaded connectors on the back side of the power unit. Connect the main tube line to the left side of the power unit with the connector and clamp provided. Do not cement this connection to the power unit in case you wish to remove at some future date. *NOTE: For paper bag units, follow directions provided with unit.* This unit may be vented outside to exhaust fumes and germs. For optimum noise reduction, this unit must be vented outside. Use the same tubing and fittings as before. Do not vent power unit exhaust into a wall, ceiling or concealed space of a building. Use two exhaust lines for twin motor units. *NOTE: On/off button on power unit is only used for the inlet on power unit. All other inlets operate automatically when hose end is inserted into inlet valve.* The power cable has a three-prong female connector on one end. This connector must be plugged into the mating connector on the power unit. Plug the other end of the power cable into the wall electrical outlet. **WIRING:** Check local codes, but use not less than #12-2 wire with ground. Plug power unit cord into appropriate electrical outlet. Be sure line voltage is sufficient to handle 20 amp load.

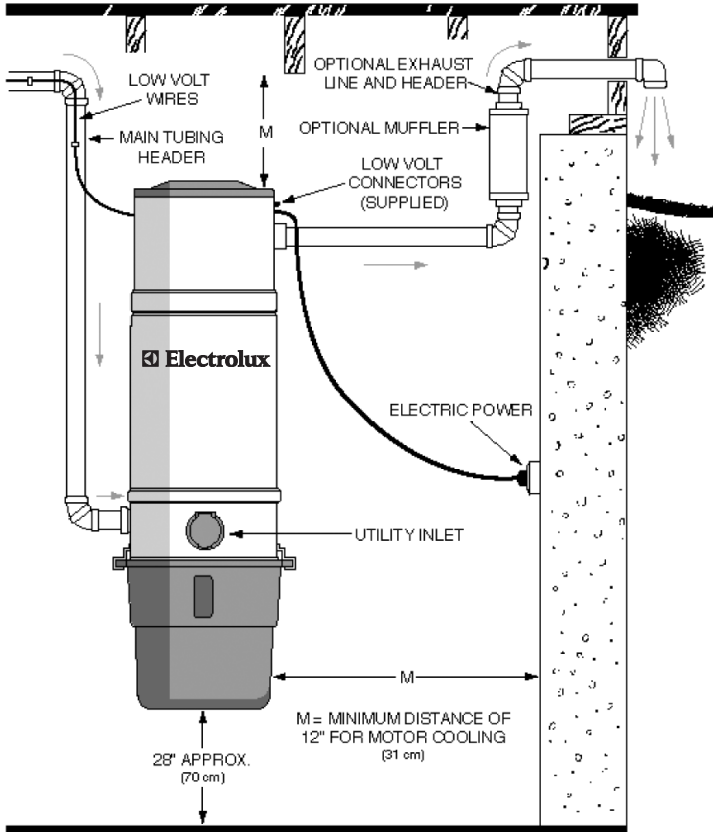

Figure 1 - Power Unit Installation

## WARNING:

Improper connection of the equipment-grounding (earthing) conductor can result in a risk of electric shock. Check with a qualified electrician or service person if you are in doubt as to whether the outlet is properly grounded (earthed). Do not modify the plug provided with the appliance. If it will not fit the outlet, have the proper outlet installed by a qualified electrician. This appliance is for use on a nominal 120 volt (see rating plate for correct voltage) circuit and has a ground (earth) plug that looks like the plug illustrated in Figure 2. Make sure that the appliance is connected to an outlet having the same configuration as the plug. No adapter should be used with this appliance.

- If the power cable is damaged, use only an OEM replacement cable.
- Check the power unit on/off button and all inlet valves for operation.
- This power unit is intended for household and commercial use only.

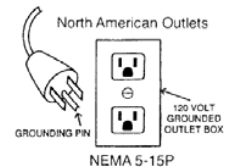

Figure 2

## Grounding (Earthing) Instructions

This appliance must be grounded (earthed). If it should malfunction or break down, grounding (earthing) provides a path of least resistance or electric current to reduce the risk of electric shock. This appliance is equipped with a cord having an equipment-grounding (earthing) plug. The plug must be plugged into an appropriate outlet that is properly installed and grounded (earthed) in accordance with all local codes and ordinances.

## Care and Maintenance

Your Electrolux Built-in Vacuum comes with a lifetime limited warranty (see complete warranty details elsewhere in this pamphlet). It will give you a lifetime of trouble-free service by following some simple guidelines:

- Motor never needs lubrication. Bearings are permanently sealed and lubricated.
- Motor brushes should be checked by your authorized Electrolux dealer after 500 hours of use.
- Power unit can be dusted off with a clean, soft cloth. **Caution: do not use liquid cleaners or water as an electrical shock may occur.**
- Do not tamper with power unit. Do not place anything on top of power unit as this could restrict cooling air to the motor, causing the motor to overheat
- Do not attempt to pick up anything that will not go through the cleaning tool or hose end. Do not use the system to pick up construction debris.
- Do not attach anything else to the system's electrical power source. Be sure that a properly-sized protected circuit is used for your unit's electrical requirements. Consult your authorized Electrolux dealer for the correct size.
- After removing the hose from the inlet, hold the inlet door open for a few seconds to help clear dirt from the vacuum tubing and make sure the power unit has been turned off.
- To ensure proper cleaning, use only one inlet at a time.
- If service is ever required, have it performed by your authorized Electrolux dealer.

## Filter Maintenance

Electrolux's exclusive filter is permanent and self-cleaning. However, if cleaning is desired, just follow these five easy steps:

1. Remove the dirt receptacle.
2. Wrap a large plastic trash bag around the lower portion of the power unit, holding it firmly in place - (as illustrated).
3. Grasp the sewn-in weight at the bottom of the filter through the bag (as shown) Shake vigorously Dirt will drop into bag
4. Carefully remove the plastic bag from the unit. Then empty the dirt receptacle into the bag, as well.
5. Replace the dirt receptacle on the power unit. Remember, any dirt that is spilled can be easily vacuumed by attaching the hose to the utility inlet and activating the power unit with the manual switch.

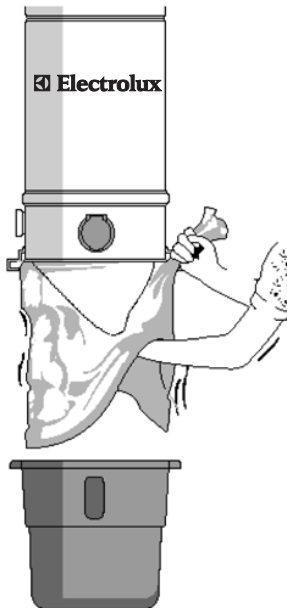

S<sub>3</sub>

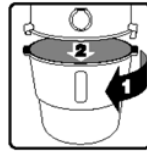

## Secure Seal System

Your Electrolux Built-in Vacuum has a Secure Seal System with an easy, twist-off bucket that also provides a tighter, longer-lasting seal.

## Trouble Shooting

### Partial Loss Of Suction

1. Clean out dirt receptacle. Inspect and clean filter (see Filter Maintenance). Replace dirt receptacle.
2. Turn ON power unit with on/off button. Then check the suction at each inlet. If it is not the same at each one, the line is partially clogged. To locate the clogged area in the system, start with the inlet closest to the power unit and check the suction. Continue to check each successive inlet until you locate the inlet where a loss in suction is occurring. The clog will be between that inlet and the previous one you checked. To remove the clog, carefully Insert an electrician's fish tape in the inlet and push the obstruction through. Or, with another vacuum, you can reverse the suction in the system to remove the clog. If neither method is successful, call your Electrolux dealer.
3. Have your authorized Electrolux dealer check the gasket under the motor and the gasket located where the dirt receptacle attaches to the upper cylinder.

### Total Loss Of Suction (with motor running)

1. Check the hose for obstruction.
2. Turn on power unit with the on/off button and follow the same procedure as in step #2 above. However, with a total loss of suction at all inlets, if the problem is a clog in the system, it would be located between the power unit and the first inlet.

### Motor Refuses To Start

1. Check fuses or breakers (trip switches) in the electric panels in your house.
2. If your power unit has a control light, the green light will indicate when the unit has proper voltage and the low-voltage circuit is supplying power to the inlets. Should the light be on, but the motor starts only with the on/off button and not at the inlets, the problem is broken low-voltage wiring to the wall inlets. Call your authorized Electrolux dealer.

 **Electrolux**